

COLD BREW  
COFFEE MACHINE

**SONIC<sup>®</sup>  
DUTCH**

**Feel the Difference**



## Contents

- 04. What is cold brew(dutch) coffee?
- 05. What is sonic dutch?
- 08. Sonic dutch product
- 16. How use to sonic cold brew coffee
- 18. How to make sonic dutch coffee
- 20. Test certification results



# Cold Brew

## What is cold brew(dutch) coffee?

Cold brew coffee(dutch coffee) means coffee extracted over a long period of time (more than 10 hours) using cold water or room temperature water. The methods of extracting cold brew coffee(dutch coffee) include the method of spotting and leaching, Which is extracted by dropping a drop of water each by using a Dutch instrument, and the method of leaching after ripening it with nut powder and water. In English, it is called Cold Brew, which means “brew in cold water.”

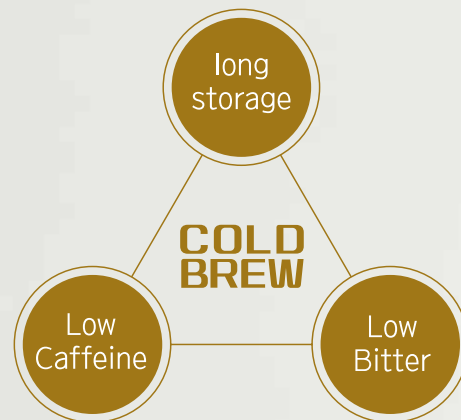

## Why? : Why do people love drinking cold brew coffee and willingly wait 10 hours for it?

Cold brew coffee is called "the wine of coffee" because the flavor component is alive and the coffee taste deepens as it ages.

### 3 Features

- ☑ Because it is extracted with cold water, it is easy to drink and has less bitter taste
- ☑ Less caffeine is extracted
- ☑ Easy to store (refrigerate for up to 3 months)

## But! : Problems of existing cold brew coffee

### Problem of long extraction time

Producing germs as the collection is prolonged for 10 to 16 hours



### Hygiene problems

Hygiene problems arise because they are exposed to air. Bacterial reproduction causes it is extracted for a long time



### High-caffeine content

Caffeine is higher than espresso because it is extracted for a long time



### Difficulty of mass extraction

Small amount of extracted coffee to long extraction time





## What is Sonic Dutch?

For the first time in the world, the sound waves of speakers are connected to the new magnetic circuit and water waves are generated through Sonic Sound Wave, which extracts cold brew coffee in 5 minutes using friction between coffee and coffee.

With the new technology, Sonic Sound Wave, you can meet the fastest, safest and freshest cold brew coffee.

Enjoy the aroma and taste of truly cold brew coffee with SONIC DUTCH!

## Unique Features of Sonic Dutch

### SPEEDY

Using the new technology of sound wave vibration and SONIC SOUND WAVE technology, Cold Brew Coffee can be extracted in a short time of 5 minutes.



### SAFE

Because the fresh beans are extracted in the short set time(5 minutes,) they can solve all types of hygiene problems such as bacteria growth and E.coli problems.



### FRESH

COLD BREW allows you to enjoy a fresh cup of coffee from freshly ground beans, just in 5 minutes. it is fresher than any other type of coffee, it has excellent flavor and aroma, and has the lowest amount of caffeine.



### REAL & VARIOUS

You can enjoy the unique aroma of coffee with the reduced bitter taste and soother texture of Real Cold Brew Coffee! You can enjoy a variety of coffee beans with a cold brew coffee.



### Check Point

- ✓ Extraction within 5 minutes
- ✓ Capacity to mass-extract at once (for household use-500ml, for commercial use-10L)
- ✓ Compatible with existing containers



# 01

## SUPER SONIC-O\_SDK-0503

: Sonic Cold Brew Coffee Maker (household use)

### Specifications

Power	220V(50/60Hz) 110v compatible
Maximum power consumption	100W
Noise level	70db and less
Dimension	W 130mm x D 130mm x H 355mm
Maximum amount of extraction	500ml/5 minutes (optimum extraction amount : 300ml)
Total weight	2.5 kg
Retail Price	\$220

### Color

- Body  LED  
 Brown  Black  White  Orange  or  White  
 Brown Black White Orange White



### Detailed Function



- 1 Time can be set(5 minute increments/up to 30 minutes)
- 2 Listening to music via Bluetooth
- 3 Sharing various information through APP
- 4 Use 25Hz with good water pulsation
- 5 Magnet Improves Vibration Strength
- 6 Easy to move with handle



### Feature

- Time can be set (5 minute increments /up to 30 minutes)
- Easy to move with handle
- Use 25Hz with good water pulsation
- Listening to music via Bluetooth

1. Certification number : R-R-SNd-SDK-0503  
 2. Certification Name : Sonic Dutch Korea Co., Ltd.  
 3. Name of equipment : Specific Low Power Radio Equipment  
 4. Manufacturer / Country of manufacture : Sonic Dutch Korea Co., Ltd. / Republic of Korea

# 02

## SUPER SONIC-H\_SDK-0412

: Sonic Cold Brew Coffee Maker (household use)

### Specifications

Power	220V(50/60Hz) 110v compatible
Maximum power consumption	100W
Noise level	70db and less
Dimension	W 140mm × D 140mm × H 110mm
Maximum amount of extraction	500ml/5 minutes (optimum extraction amount : 300ml)
Total weight	2.5 kg
Retail Price	\$330

### Color

Body    LED    Deco  
Black or White or Mint or Pink    Orange or White    Rose Gold or Chrome  
 Black White Mint Pink Orange White Rose Gold Chrome



### Detailed Function



>> Upper part

- ❶ Bluetooth On/Off
- ❷ Time setting

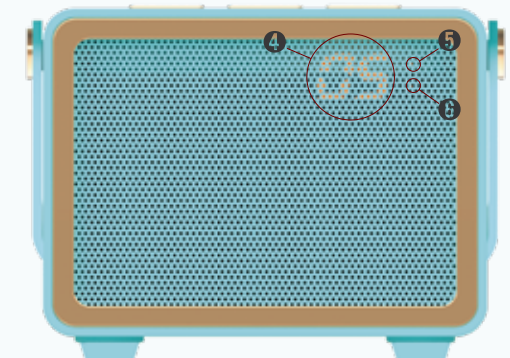

>> Front part

- ❸ Play Start/Stop
- ❹ Time display
- ❺ Bluetooth power display
- ❻ Bluetooth pairing-Link display



### Feature



Time can be set (5 minute increments /up to 30 minutes)



Easy to move with handle



Use 25Hz with good water pulsation



Listening to music via Bluetooth

1. Certification number : R-R-SNd-SDK-0412  
 2. Certification Name : Sonic Dutch Korea Co., Ltd.  
 3. Name of equipment : Specific Low Power Radio Equipment  
 4. Manufacturer / Country of manufacture : Sonic Dutch Korea Co., Ltd./ Republic of Korea

Acquired US FCC, European CE, Japan MIC, and Taiwan NEE certifications

# 03

## SUPER SONIC-S1

SDK-1028

: Sonic Cold Brew Coffee Machine  
(household use / commercial use)

### Specifications

Power	220V(50/60Hz) 110v compatible
Maximum power consumption	200W
Noise level	70db and less
Dimension	W 345mm x D 206mm x H 155mm
Maximum amount of extraction	1L/5 minutes(optimum extraction amount : 500ml)
Total weigh	3.5Kg
Retail Price	\$660

### Color

- |             |              |             |
|-------------|--------------|-------------|
| Body        | LED          | Deco        |
| ● or ●      | ● or ●       | ● or ●      |
| Black White | Orange White | Gold Chrome |

- 1. Certification number : R-C-SNd-SDK-1028
- 2. Certification Name : Sonic Dutch Korea Co., Ltd.
- 3. Name of equipment : Specific Low Power Radio Equipment
- 4. Manufacturer / Country of manufacture : Sonic Dutch Korea Co., Ltd./ Republic of Korea

Acquired US FCC, Japan MIC certifications

### Detailed Function



- 1 Vibrating table
- 2 Power switch
- 3 Automatic memory device
- 4 Bluetooth On/Off
- 5 Time controller unit
- 6 Hz control unit
- 7 Vibration intensity control unit
- 8 Multipurpose Cradle
- 9 USB charging



### Features



Time can be set  
(Set up to 60 minutes)



Auto save function

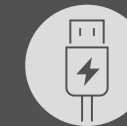

USB charging function



Use the 20-35Hz band  
with the best water wave



0~99% adjustable  
vibration intensity



Multi-purpose stand function  
(smart phone stand possible)



Sharing various  
information through APP



Listening to music via  
Bluetooth

# 04

## SUPER SONIC-M SDK-7409

: Sonic Cold Brew Coffee Machine  
(for commercial use)

### Specifications

Power	220V(50/60Hz) 110v compatible
Maximum power consumption	700W
Noise level	70db and less
Dimension	W 400mm × D 300mm × H 200mm
Maximum amount of extraction	10L/5 minutes(optimum extraction amount : 6L)
Total weight	20Kg
Retail Price	\$3,300

### Color



## Detailed Function



- ① Time setting
- ② Automatic memory device
- ③ Hz adjustment/Bluetooth function
- ④ Vibration intensity control  
/Power unit/Operating unit



## Feature



Time can be set  
(Set up to 60 minutes)



Auto save function



Frequency adjustable from 5-50Hz  
(adjustable up to decimal point)



0-99% adjustable  
vibration intensity



Sharing various information  
through APP



Listening to music  
via Bluetooth



1. Certification number : R-CMM-SNd-SDK-7409
2. Certification Name : Sonic Dutch Korea Co., Ltd.
3. Name of equipment : Specific Low Power Radio Equipment
4. Manufacturer / Country of manufacture : Sonic Dutch Korea Co., Ltd./ Republic of Korea

## How to Extraction?



STEP 01

Grind the beans  
(Grinding degree of Dutch or hand drip thickness)



STEP 02

Put the ground into a container



STEP 03

Pour water  
(not too cold)

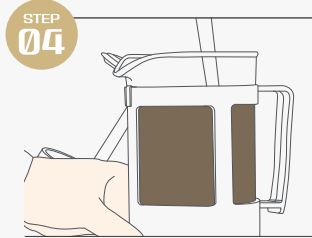

STEP 04

Mix the beans and water with a spoon  
(Float the sunken coffee)

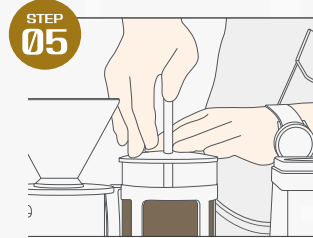

STEP 05

Close the lid and press the press lightly (about 1 to 2 cm)

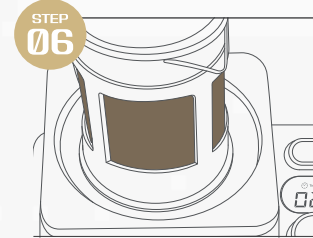

STEP 06

Put the container on the plate

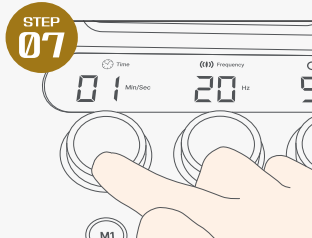

STEP 07

After setting the operation time, sound wave, and vibration intensity, press the start button.  
- Super Sonic-H can only set the time



STEP 08

Check the water for waves



STEP 09

Open the top press lid and stir with a spoon



STEP 10

Pour the coffee grounds all at once and filter through a paper filter



STEP 11

Add ice and water according to your preference and add the extracted Sonic Cold Brew undiluted solution



STEP 12

If you mix water and cold brew coffee extract well, delicious sonic cold brew coffee is complete!

## Precautions for use

- ① Use on a hard and flat floor.
- ② When using, place the enclosed pad under the body before use.
- ③ Be sure to follow the recommended usage of 100g of ground coffee and 500ml of water.  
※ However, when using a 1L container, 150g of beans and 750ml of water ※
- ④ It is recommended to use coffee beans for Dutch or hand-drip grinding.
- ⑤ It is better to use room temperature water rather than too cold water.
- ⑥ Stir with a spoon to allow the sunken beans to rise completely before closing the lid.
- ⑦ Before operation, press the press 1~2cm so that the ground beans are slightly immersed in the water.
- ⑧ Supersonic-S1 and Supersonic-M are powered on by pressing and holding the rightmost dial of the front dials for about 3 to 4 seconds with the power switch turned on.

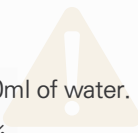

# Application

## Tips on extracting the best cold brew coffee with Sonic Dutch

- ☑ – For fresh taste, use the coffee bean within 2 to 15 days after roasting  
(The best result can be obtained by using the coffee bean 5 to 10 days after roasting)
- ☑ – Grind coffee beans not too finely, using a grinder.  
(The best coffee bean grind level is either for hand drip or a cold brew)
- ☑ – See below for the blend ratio of coffee bean and water.



### Traditional cold brew coffee

01

#### Traditional cold brew coffee

Based on French press container (700ml)  
Beans 1: Extracted by blending at a ratio of room temperature water 5

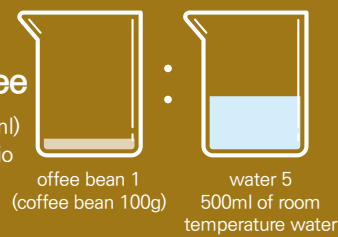

02

#### Light cold brew coffee

Based on French press container (700ml)  
Beans 0.5: Extracted by blending at a ratio of room temperature water 5

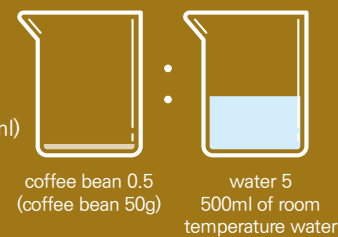

03

#### Strong cold brew coffee

Based on French press container (700ml)  
Beans 1.5: Extracted by blending at a ratio of room temperature water 5

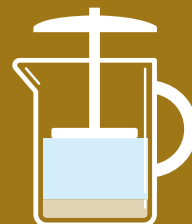
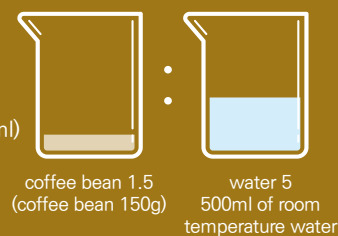

# Recipe

### Ice cold brew coffee



Mix cold brew extract and water at ratio of 1:3 and add ice as you prefer.

### Hot cold brew coffee

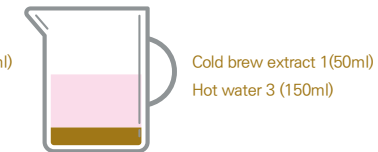

Mix cold brew extract and water at ratio of 1:3 and add 1 to 2 pumps of syrup as you desire (you can a microwave)

### Cold brew latte



Mix cold brew extract and milk at ratio of 1:3 Milk may be replaced with soy milk as you prefer.

### Cold brew affogato



Add ice cream as you like and pour the cold brew extract on top to enjoy

### Cold brew ade



Mix cold brew extract and Cider at ratio of 1:3 and add ice as you prefer.

### Cold brew mocha coffee

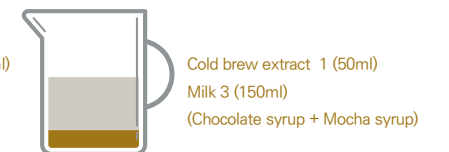

Mix cold brew extract and milk at a ratio of 1:3 and add chocolate or mocha syrup as you prefer.

### Cold brew under lock



Add 50ml of cold brew extract and fill the cup with ice to enjoy a deep flavor

### Cold brew beer



Mix the cold brew extract and beer at a ratio of 1:3 and you can enjoy a "coffee beer"

### Cold brew soju



If you add 50ml of cold brew undiluted solution to a bottle of soju, you can enjoy coffee-flavored soju instead of the bitter taste of soju.

## Caffeine content and safety

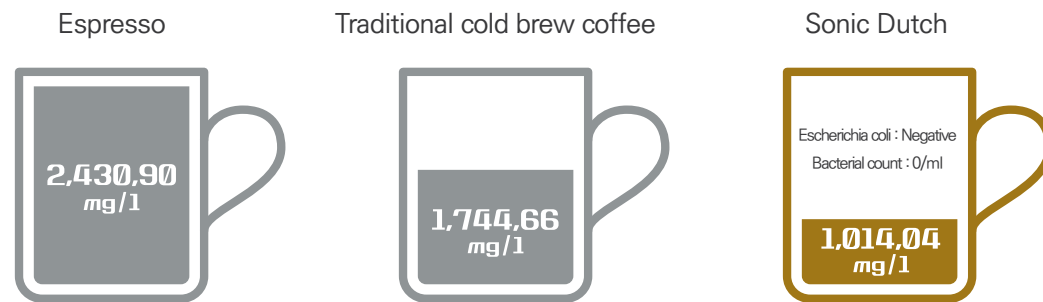

**Test certification results** It has 50% less caffeine compared to espresso and regular Dutch. E. coli and bacteria are not detected with extraction in the shortest time.

## Coffee taste test

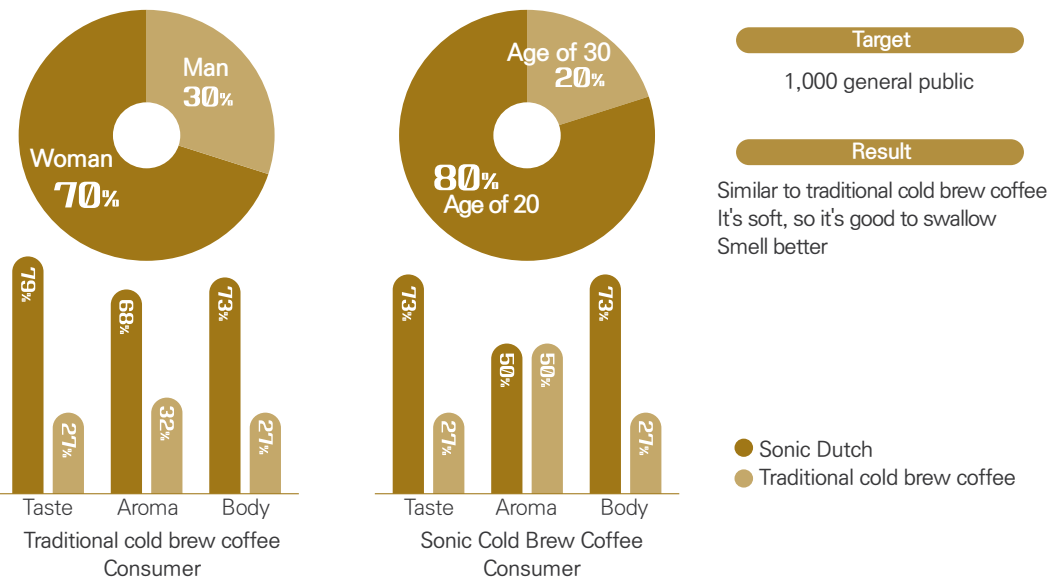

## Certificates

Sonic Dutch Korea was created based on the know-how accumulated through various experiences and numerous certifications.



7 domestic patents, 1 overseas US patent, 1 Chinese patent, 1 Japanese patent registration, design, trademark registration, overseas PCT application, etc.



**SONIC DUTCH KOREA Co.,Ltd.**

Add | 64, Yeonsuwon-ro, Danwon-gu, Ansan-si, Gyeonggi-do, Republic of Korea (15432) Tel : +82-10-7233-0754

Cafe | [cafe.naver.com/sonicdutch](http://cafe.naver.com/sonicdutch) Instagram | [www.instagram.com/sonicdutch](http://www.instagram.com/sonicdutch)

Blog | [blog.naver.com/sonicdutch](http://blog.naver.com/sonicdutch) facebook | [www.facebook.com/soniccoldbrew](http://www.facebook.com/soniccoldbrew)

E-mail | [info@soniccoldbrew.coffee](mailto:info@soniccoldbrew.coffee)